

olivia™

THE TRAVEL COMPANY FOR LGBTQ+ WOMEN

PORTUGAL DOURO RIVER CRUISE

MAY 8-15, 2024

on board Avalon's brand new
ms *Alegria*

PORTO | ENTRE-OS-RIOS |
PESO DA RÉGUA |
POCINHO | BARCA D'ALVA /
SALAMANCA | CALDAS DE
AREGOS / AMARANTE | PORTO



Like a blue ribbon, threading through the green Douro Valley, the River Douro carries you through some of Portugal's most legendary landscapes. Meaning "River of Gold," the Douro River lives up to its name by revealing priceless gems along sloping vineyards and sleepy villages where rugged landscapes have been tamed for centuries to produce a bounty of wines and cuisine. Be swept away by Douro's timeless treasures and traditions, family farms and fevered Fado music, and mouth-watering culinary creations in the world's oldest demarcated wine region.





ITINERARY SUMMARY

Wednesday, May 8, 2024

Thursday, May 9, 2024

Friday, May 10, 2024

Saturday, May 11, 2024

Sunday, May 12, 2024

Monday, May 13, 2024

Tuesday, May 14, 2024

Wednesday, May 15, 2024

Porto, Portugal (all aboard at 5 pm)

Entre-os-Rios, Portugal

Peso da Régua, Portugal

Pocinho, Portugal

Barca d'Alva / Salamanca, Portugal

Caldas de Aregos / Amarante, Portugal

Porto, Portugal (overnight)

Porto, Portugal (disembark)

**Itinerary is subject to change due to weather, locks, schedule, river traffic, and water levels.*

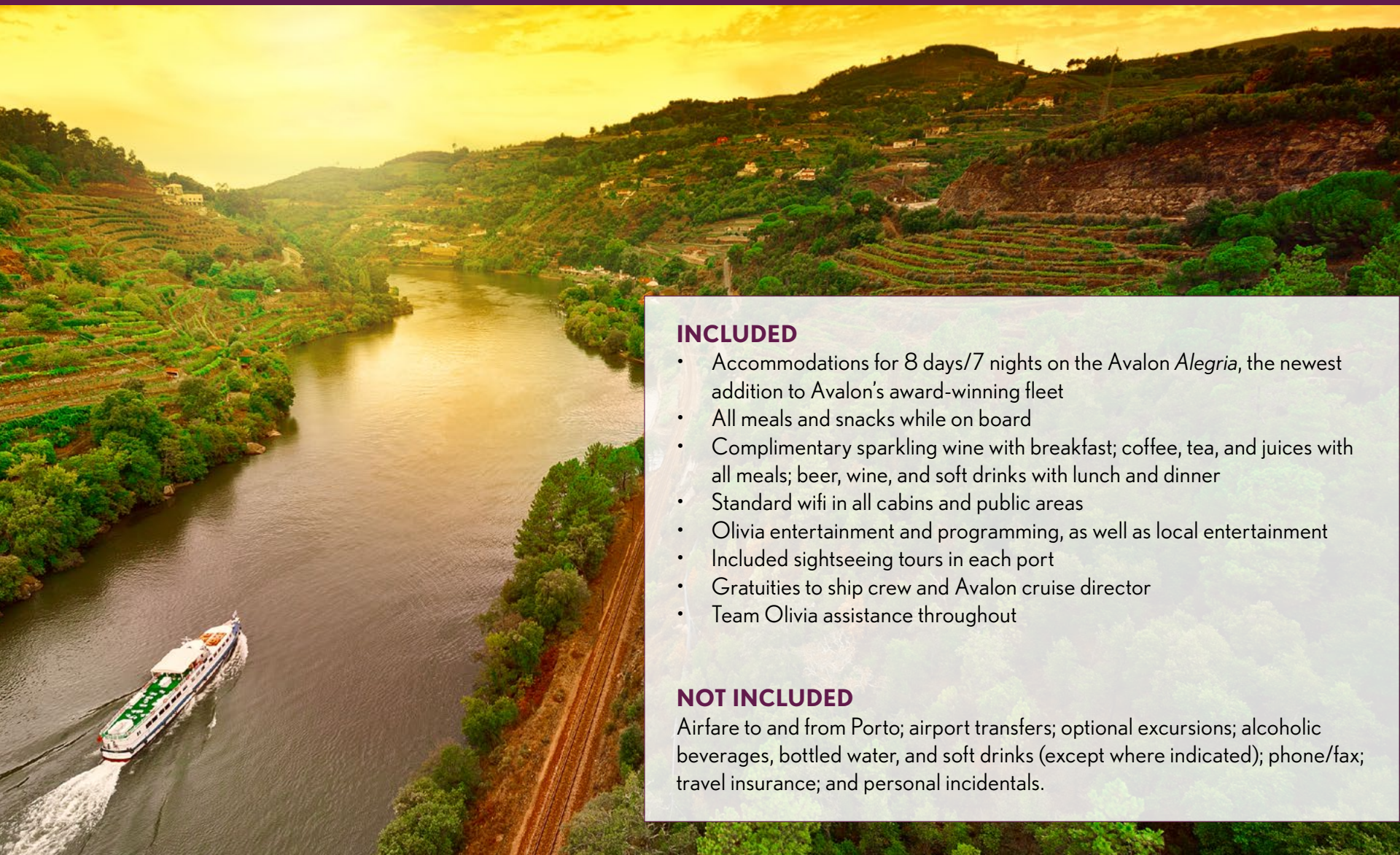

INCLUDED

- Accommodations for 8 days/7 nights on the *Avalon Alegria*, the newest addition to Avalon's award-winning fleet
- All meals and snacks while on board
- Complimentary sparkling wine with breakfast; coffee, tea, and juices with all meals; beer, wine, and soft drinks with lunch and dinner
- Standard wifi in all cabins and public areas
- Olivia entertainment and programming, as well as local entertainment
- Included sightseeing tours in each port
- Gratuities to ship crew and Avalon cruise director
- Team Olivia assistance throughout

NOT INCLUDED

Airfare to and from Porto; airport transfers; optional excursions; alcoholic beverages, bottled water, and soft drinks (except where indicated); phone/fax; travel insurance; and personal incidentals.



AVALON MS ALEGRIA

Explore Portugal's dazzling Douro River on Avalon's newest addition to its award-winning fleet of Suite Ships®. The Avalon Alegria delights river cruisers with exceptional experiences and the elegant yet relaxed luxury you've come to expect from Avalon Waterways.

The Avalon Alegria certainly lives up to its name, meaning happiness, which flows from stem to stern on this 262-foot ship. The ship features two full decks of award-winning Panorama Suites, featuring wall-to-wall and floor-to-ceiling panoramic windows that transform your living space into a unique Open-Air Balcony. The 200-square-foot Panorama Suites are more than 30% larger than the industry standard, with Avalon's signature window-facing "Beds with a View." Onboard amenities include complimentary wifi access, a state-of-the-art Fitness Center, an Adventure Center with complimentary active gear, and an Avalon Adventure Host to assist with active excursions and on board fitness classes and activities. Enjoy exceptional onboard cuisine, including Avalon Fresh® menu options, premium coffee, and spirits, and versatile FlexDining venues, including the casual Panorama Bistro, al fresco Sky Grill, or elegant glass-walled Dining Room. Make yourself at home in the Club lounge with a variety of coffees, teas, cold beverages, and pastries while settling in with your pick of books, cards, and board games. Relax and watch the world go by in the Observation Lounge for the perfect vantage point to peruse Portugal's stunning Douro Valley and vineyards. Stretch out on the Sky Deck with a swimming pool, premium lounge chairs, and shade system to relax while sailing through Portugal's most spectacular views!

Total Occupancy: 102 guests



Some of the other features and amenities you'll enjoy on board:

- Complimentary wifi
- Panoramic windows
- Elegant, contemporary design & décor
- Friendly, English-speaking crew and Cruise Director
- Sky Deck with whirlpool, shade awnings, game area and premium lounges
- Covered Observation Lounge
- Club Lounge with 24-hour self-serve beverage station with complimentary cappuccinos, lattes, tea, hot chocolate, and premium coffees, as well as treats throughout the day
- Elevator
- Bikes, walking sticks, binoculars, daypacks
- Maps for hiking, biking, and jogging routes

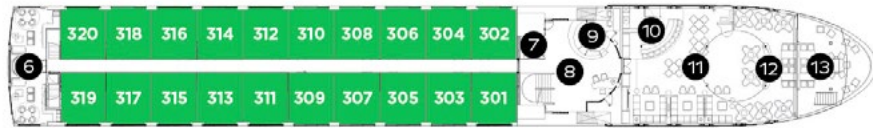

DECK PLAN

- 1 Sky Lounge
- 2 Premium Lounge Chairs and Shade Awnings
- 3 Sky Grill
- 4 Pool
- 5 Navigation Bridge
- 6 Club Lounge
- 7 Elevator
- 8 Adventure Center
- 9 Guest Services
- 10 Bar
- 11 Panorama Lounge
- 12 Panorama Bistro
- 13 Observation Lounge
- 14 Dining Room
- 15 Galley
- 16 Fitness Center

CATEGORIES

- Cat. P** Royal Deck | Panorama Suites
- Cat. A** Sapphire Deck Forward | Panorama Suites
- Cat. B** Sapphire Deck Aft | Panorama Suites
- Cat. D** Indigo Deck | Deluxe Staterooms
- Cat. E** Indigo Deck | Deluxe Staterooms

ROYAL DECK



DECK PLAN

- 1 Sky Lounge
- 2 Premium Lounge Chairs and Shade Awnings
- 3 Sky Grill
- 4 Pool
- 5 Navigation Bridge
- 6 Club Lounge
- 7 Elevator
- 8 Adventure Center
- 9 Guest Services
- 10 Bar
- 11 Panorama Lounge
- 12 Panorama Bistro
- 13 Observation Lounge
- 14 Dining Room
- 15 Galley
- 16 Fitness Center

CATEGORIES

- Cat. P** Royal Deck | Panorama Suites
- Cat. A** Sapphire Deck Forward | Panorama Suites
- Cat. B** Sapphire Deck Aft | Panorama Suites
- Cat. D** Indigo Deck | Deluxe Staterooms
- Cat. E** Indigo Deck | Deluxe Staterooms

INDIGO DECK



DECK PLAN

- 1 Sky Lounge
- 2 Premium Lounge Chairs and Shade Awnings
- 3 Sky Grill
- 4 Pool
- 5 Navigation Bridge
- 6 Club Lounge
- 7 Elevator
- 8 Adventure Center
- 9 Guest Services
- 10 Bar
- 11 Panorama Lounge
- 12 Panorama Bistro
- 13 Observation Lounge
- 14 Dining Room
- 15 Galley
- 16 Fitness Center

CATEGORIES

- Cat. P** Royal Deck | Panorama Suites
- Cat. A** Sapphire Deck Forward | Panorama Suites
- Cat. B** Sapphire Deck Aft | Panorama Suites
- Cat. D** Indigo Deck | Deluxe Staterooms
- Cat. E** Indigo Deck | Deluxe Staterooms

SAPPHIRE DECK

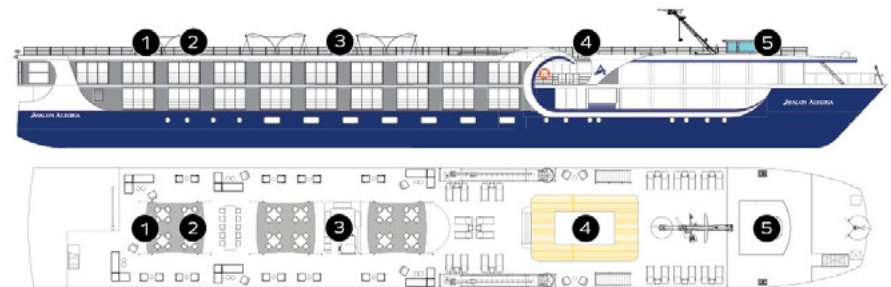

DECK PLAN

- 1 Sky Lounge
- 2 Premium Lounge Chairs and Shade Awnings
- 3 Sky Grill
- 4 Pool
- 5 Navigation Bridge
- 6 Club Lounge
- 7 Elevator
- 8 Adventure Center
- 9 Guest Services
- 10 Bar
- 11 Panorama Lounge
- 12 Panorama Bistro
- 13 Observation Lounge
- 14 Dining Room
- 15 Galley
- 16 Fitness Center

CATEGORIES

- Cat. P** Royal Deck | Panorama Suites
- Cat. A** Sapphire Deck Forward | Panorama Suites
- Cat. B** Sapphire Deck Aft | Panorama Suites
- Cat. D** Indigo Deck | Deluxe Staterooms
- Cat. E** Indigo Deck | Deluxe Staterooms

SKY DECK



DELUXE STATEROOM, CATEGORY E

EARLY BIRD \$4,999 PP REGULAR \$6,499 PP

Located on the Indigo deck, this Deluxe Stateroom features small windows, a Comfort Collection bed that can convert to two single beds, soft and firm pillows, Egyptian super-combed cotton linens, flat-screen satellite TV with movie channels, telephone, minibar, full shower with glass doors, robes, slippers, writing desk and chair, and full-length closets. Windows are high on the wall and do not open. Room is below the water line. 172 sq. ft

DELUXE STATEROOM, CATEGORY D

EARLY BIRD \$5,099 PP REGULAR \$6,599 PP

Located on the Indigo deck, this Deluxe Stateroom features small windows, a Comfort Collection bed that can convert to two single beds, soft and firm pillows, Egyptian super-combed cotton linens, flat-screen satellite TV with movie channels, telephone, minibar, full shower with glass doors, robes, slippers, writing desk and chair, and full-length closets. Windows are high on the wall and do not open. Room is below the water line. 172 sq. ft.

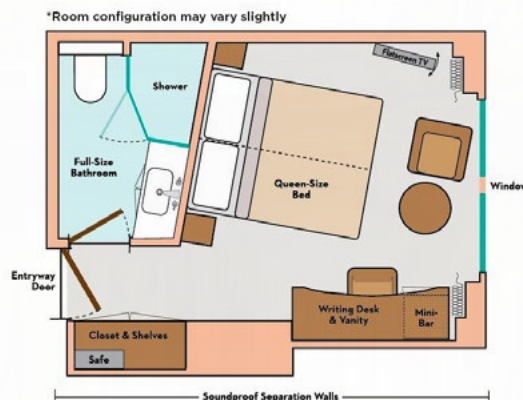



PANORAMA SUITE, CATEGORY B

EARLY BIRD \$6,499 PP REGULAR \$8,499 PP

Located on the Sapphire Deck, this Panorama Suite features floor-to-ceiling windows, sliding glass doors, a Comfort Collection bed that can convert into two singles, soft and firm pillows, Egyptian super-combed cotton linens, flat-screen satellite TV with movie channels, telephone, minibar, full-sized bathroom with marble counter, full shower with glass door, robes, slippers, writing desk, chair, sofa, coffee table, and full-length closets. 200 sq. ft.



PANORAMA SUITE, CATEGORY A

EARLY BIRD \$6,599 PP REGULAR \$8,599 PP

Located on the Sapphire Deck, this Panorama Suite features floor-to-ceiling windows, sliding glass doors, a Comfort Collection bed that can convert into two singles, soft and firm pillows, Egyptian super-combed cotton linens, flat-screen satellite TV with movie channels, telephone, minibar, full-sized bathroom with marble counter, full shower with glass door, robes, slippers, writing desk, chair, sofa, coffee table, and full-length closets. 200 sq. ft.

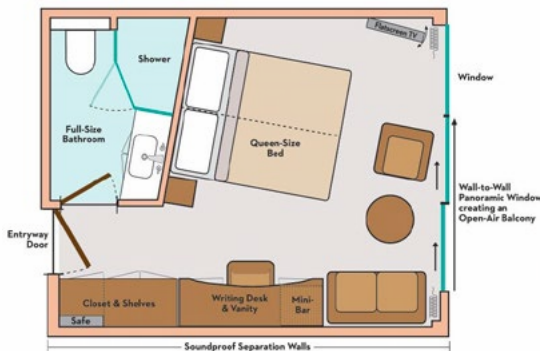

PANORAMA SUITE, CATEGORY P

EARLY BIRD \$6,699 PP REGULAR \$8,699 PP

Located on the Royal Deck, this Panorama Suite features floor-to-ceiling windows, sliding glass doors, a Comfort Collection bed that can convert into two singles, soft and firm pillows, Egyptian super-combed cotton linens, flat-screen satellite TV with movie channels, telephone, minibar, full-sized bathroom with marble counter, full shower with glass door, robes, slippers, writing desk, chair, sofa, coffee table, and full-length closets. 200 sq. ft.



Wednesday, May 8, 2024 | Porto, Portugal (Embarkation)

Welcome to Portugal! Flights into Porto must arrive by 3:30 pm and guests must be on board by 5 pm. Your day in Porto is free to explore at your leisure. If you arrive early, you may drop off your luggage and choose to join an optional afternoon guided culinary tour. Experience some of Porto's most famous sights and most delectable dishes with regional wine. Enjoy dinner and explore your riverboat on your first night on board.
(-/-/D)

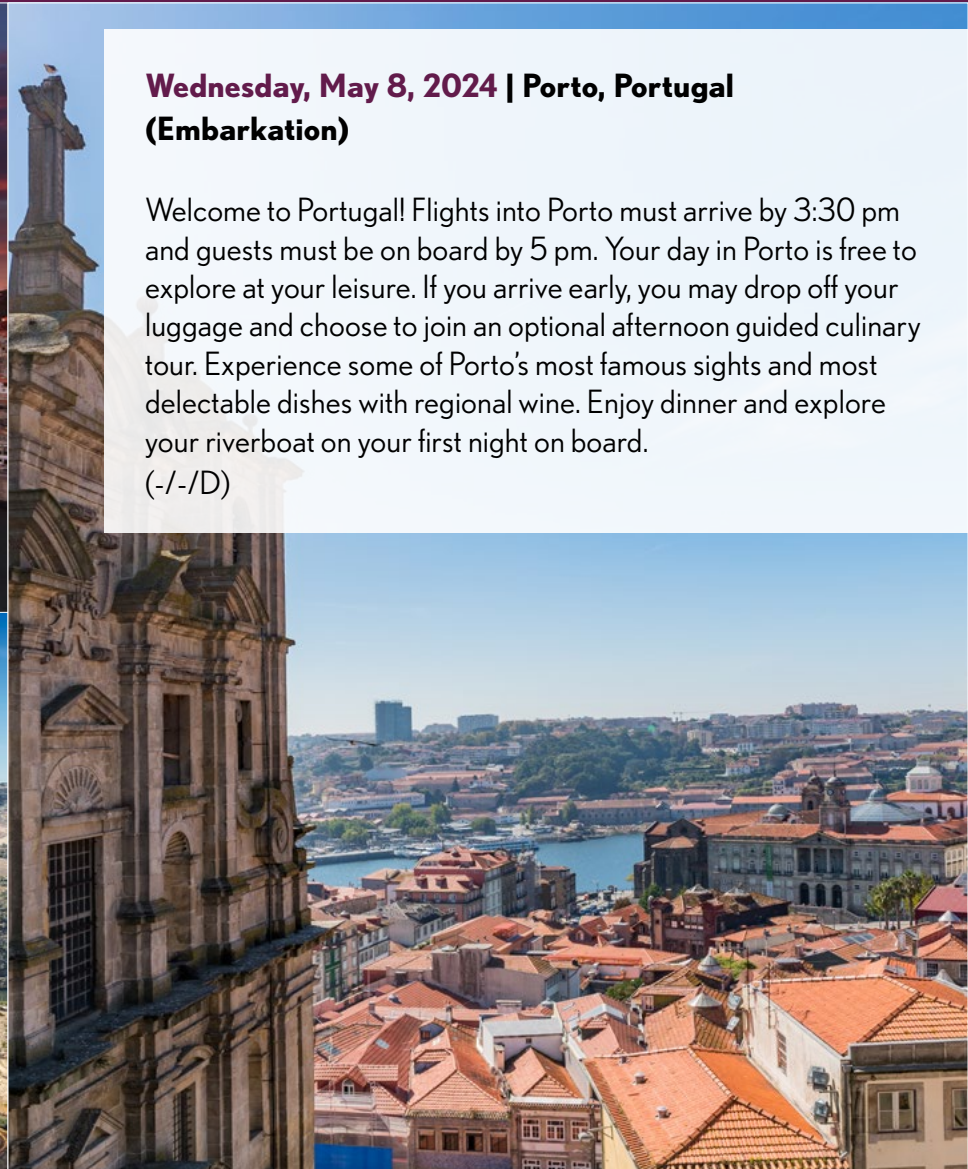

Thursday, May 9, 2024 | Entre-os-Rios, Portugal

Portuguese Panoramas

Choose from Discovery or Classic tours. With Discovery, step back in time with the walls of the Interpretation Center of the Romanesque with a fascinating introduction to its symbolism and architecture. Enjoy an excursion with an exclusive visit to one of the most iconic monasteries of the Romanesque era with entrance to a XIII century church and be enchanted by sounds of Gregorian Chant from the high choir. The Classic tour today, takes you to a world of Celtic history and the reign of Cesar Augustus where five roads diverged to form an empire with a full-day guided tour of Braga. Marvel at the magnificent castle and San Miguel church in Guimarães, a UNESCO World Heritage Site. Celebrate your experience with a stop at one of the area's many wine farms and enjoy a tasting. Sample green wine and famous pastries with stops en route to Régua. (B/L/D)

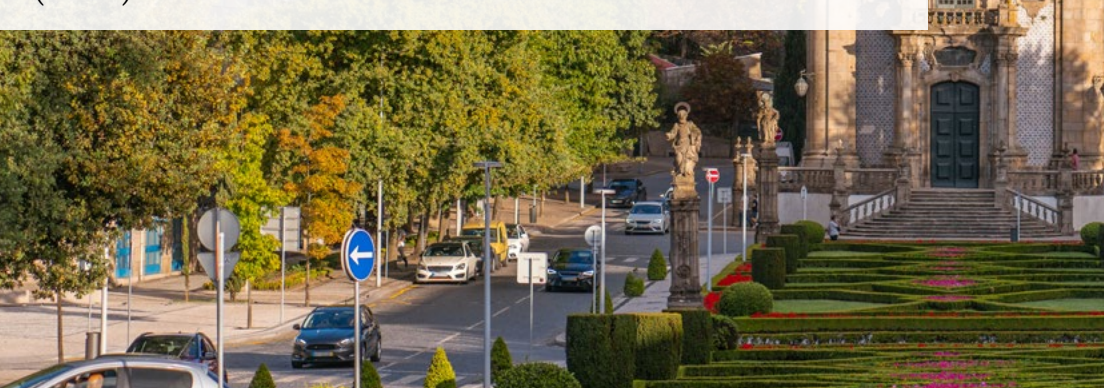

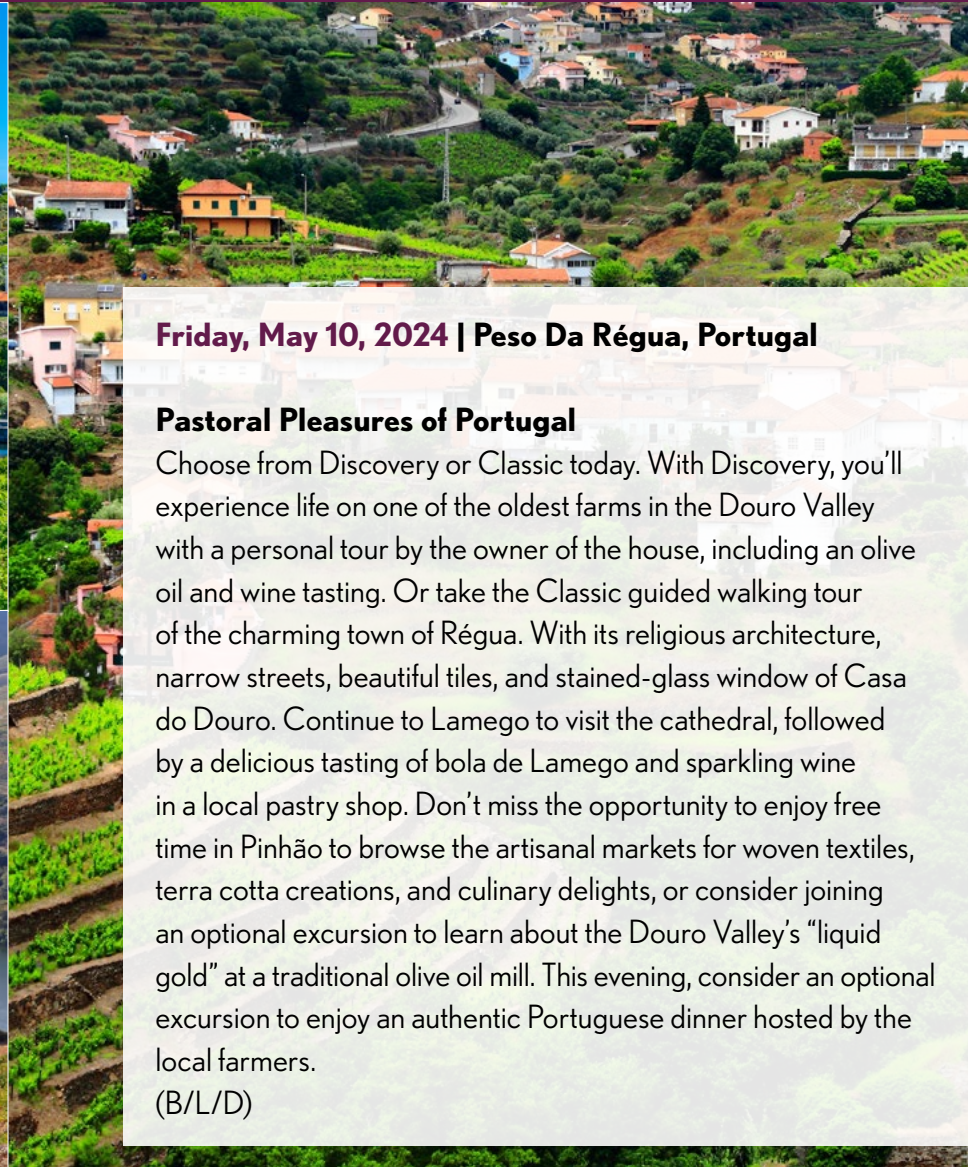

Friday, May 10, 2024 | Peso Da Régua, Portugal

Pastoral Pleasures of Portugal

Choose from Discovery or Classic today. With Discovery, you'll experience life on one of the oldest farms in the Douro Valley with a personal tour by the owner of the house, including an olive oil and wine tasting. Or take the Classic guided walking tour of the charming town of Régua. With its religious architecture, narrow streets, beautiful tiles, and stained-glass window of Casa do Douro. Continue to Lamego to visit the cathedral, followed by a delicious tasting of bola de Lamego and sparkling wine in a local pastry shop. Don't miss the opportunity to enjoy free time in Pinhão to browse the artisanal markets for woven textiles, terra cotta creations, and culinary delights, or consider joining an optional excursion to learn about the Douro Valley's "liquid gold" at a traditional olive oil mill. This evening, consider an optional excursion to enjoy an authentic Portuguese dinner hosted by the local farmers.

(B/L/D)



Saturday, May 11, 2024 | Pocinho, Portugal

Written in Stone

Enjoy a relaxing cruise to Pocinho for a day in the Terra Quente region. Choose from a Discovery or Classic tour. Discover Vila Nova de Foz Côa at the eastern terminal of the legendary Douro Railway line. Marvel at the amazing archaeological site along the River Côa where a wealth of remarkable prehistoric rock paintings and carvings were discovered as the most significant collection of open-air Paleolithic figurations known today. Before returning to your riverboat, enjoy a tasting of the unique wine of the region. Or choose the Classic guided tour of Freixo de Numão, a charming village nestled between the nearby mountains. Visit a local farm for a delightful wine tasting where sustainable farming practices have recovered some of the region's 100 original grape varieties.

(B/L/D)



Sunday, May 12, 2024 | Barca D'Alva / Salamanca, Portugal

Today offers to Classic tours. Join a guided tour this morning to one of the most remote villages of the country, Freixo de Espada à Cinta village in the Douro International Natural Park, home to majestic birds of prey. Or get a taste of Spain with a full-day excursion to Salamanca. This Spanish city will take your breath away with its stunning streets and squares, featuring a feast for the eyes with Romanesque, Gothic, Baroque, and "Plateresque" architecture. Dive into a delicious dish of the traditional Spanish delicacy, tostón asado (traditional roast suckling pig). In the afternoon you might wish to join our optional excursion to enjoy a do-it-yourself workshop to learn how to bake traditional Florinhas (Portuguese pastries). (B/L/D)



Monday, May 13, 2024 | Caldas De Aregos / Amarante, Portugal

Painted Tiles & Passionate Tunes

During your morning sailing, a professional painter will guide you through the process of painting an azulejos (traditional Portuguese tile) to take home a piece of Portugal's tradition. You may alternatively join an optional excursion to 18th-century Casa de Mateus—birthplace of Mateus Rosé wine and a masterpiece of Baroque architecture. Later, join the Classic guided sightseeing of Amarante—poised against a breathtaking backdrop of the great Serra do Marão mountain and the Tâmega River, which courses through the heart of the city and assortment of houses lining the riverbanks. In the evening, feel the passion of Portugal's soulful and stirring Fado music during a visit with local musicians on board. (B/L/D)





Tuesday, May 14, 2024 | Porto, Portugal

Ancient Charm Meets Avant-Garde

Choose from Classic or Active today. With Classic, you'll enjoy a guided sightseeing tour of Porto, a UNESCO World Heritage site. Continue your experience with a ride to the riverside city of Matosinhos and up Avenida da Boavista to admire some of the modern charms of Porto—from ancient avenues to avant-garde graffiti street art. Or go the Active route and take a scenic bike ride to pedal through picturesque surroundings from Porto to the Atlantic Coast. In the afternoon, you may choose to join in a guided optional excursion such as a scenic canal cruise on the Aveiro (Venice of Portugal) or explore a family-owned factory to witness the Portuguese art of cork and barrel production. Or spend time strolling through Porto's cobblestone lanes, lovely shops, and tempting tapas bars before experiencing the energy of Porto's buzzing nightlife. (B/L/D)

Wednesday, May 15, 2024 | Porto, Portugal (Disembarkation)

Your cruise ends with breakfast in the morning.
(B/-/-)



CATEGORY

DELUXE STATEROOM, CATEGORY E

Located on the Indigo deck, this Deluxe Stateroom features small windows below the waterline. 172 sq ft.

DELUXE STATEROOM, CATEGORY D

Located on the Indigo deck, this Deluxe Stateroom features small windows below the waterline. 172 sq ft.

PANORAMA SUITE, CATEGORY B

Located on the Sapphire deck, this Panorama Suite features floor-to-ceiling windows. 200 sq ft.

PANORAMA SUITE, CATEGORY A

Located on the Sapphire deck, this Panorama Suite features floor-to-ceiling windows. 200 sq ft.

PANORAMA SUITE, CATEGORY P

Located on the Royal deck, this Panorama Suite features floor-to-ceiling windows. 200 sq ft.

PRICING PP

EARLY-BIRD: \$4,999

REGULAR: \$6,499

EARLY-BIRD: \$5,099

REGULAR: \$6,599

EARLY-BIRD: \$6,499

REGULAR: \$8,499

EARLY-BIRD: \$6,599

REGULAR: \$8,599

EARLY-BIRD: \$6,699

REGULAR: \$8,699

faq

ACTIVITY LEVEL

This trip requires some mobility without the use of a wheelchair or scooter, as most tours are walking tours for up to 3 hours, which may include walking on cobblestone streets and stairs. A 'Gentle Walkers' group is offered on most included walking tours, which accommodates those needing a little extra time and sometimes offers a shortened version of a tour, designed to encounter as few stairs as possible.

If you are bringing a portable wheelchair or collapsible travel scooter, you must be able to collapse it and store it in your cabin. It cannot be used to get around the ship, only while off the ship on tours that are wheelchair/scooter accessible. On tours, the usefulness of a portable wheelchair or scooter may be limited because we will be navigating cobblestone streets with hard curbs (no curb ramps) and stairs.

If you have limited mobility, you are required to travel with someone who can assist you.

AIRFARE

Please check our airline discounts page for the latest discounts:

<https://www.olivia.com/airfare-specials>

FLIGHTS

You will need to fly into and out of **Porto International Airport (OPO)**. We encourage all guests to arrive at least one day early to avoid the stress of unexpected delays.

Your flight into Porto International Airport (OPO) should arrive by 2 pm on May 8, 2024.

Your flight can depart anytime on May 15, 2024 since we overnight in Porto.



oliviaTM



CALL YOUR OLIVIA TRAVEL CONSULTANT
USA & CANADA: [800-631-6277](tel:800-631-6277) INTERNATIONAL: [415-962-5700 X1](tel:415-962-5700)

